

LuxEOS Flood 9 VIVID COLOUR

LED FLOOD FOR ARCHITECTURAL LIGHTING



LuxEOS Flood 9 - RGBA (1700K)
10° 20° 40° 80° 10x60° 60x10°

Tested By
DW Windsor Group Laboratory
Hoddesdon
UK

Date
Nov 2020

Dimensions
350mm (H) x 255mm (W) x 150mm (D) (including yoke)

Weight
7.2 kgs (15.9lbs)

Polar Distribution

10° Conical Beam (Native)

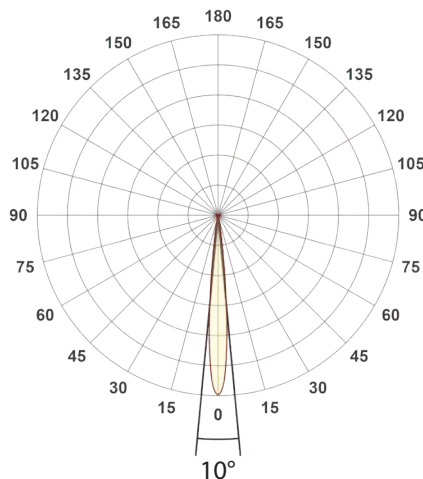

20° Conical Beam (With HBS)

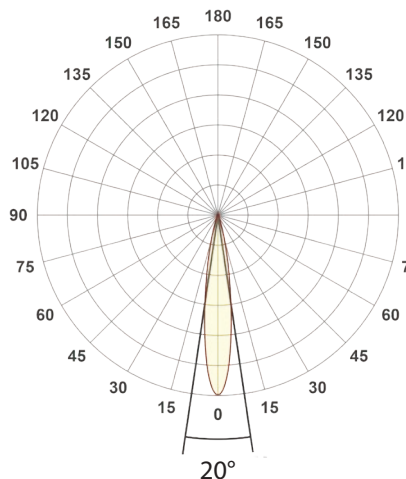

40° Conical Beam (With HBS)

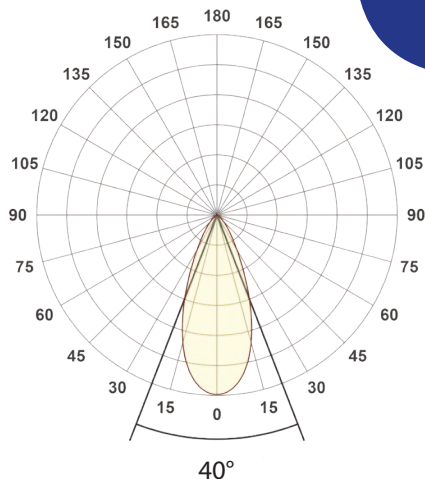

80° Conical Beam (With HBS)

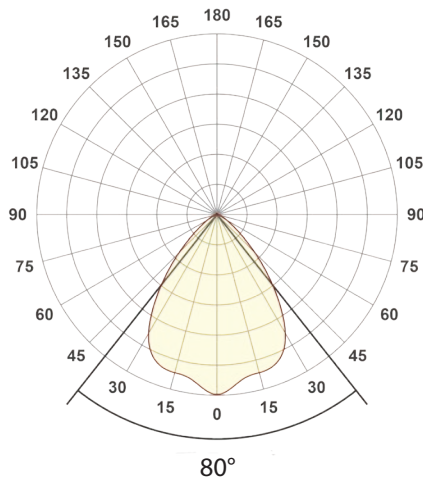

10x60° / 60x10° Elliptical Beam (With HBS)

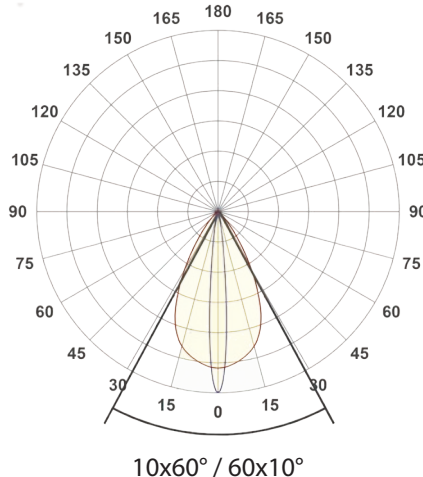

LuxEOS Flood 9 - RGBA (1700K)

Intensities at Distance with native 10° Optics

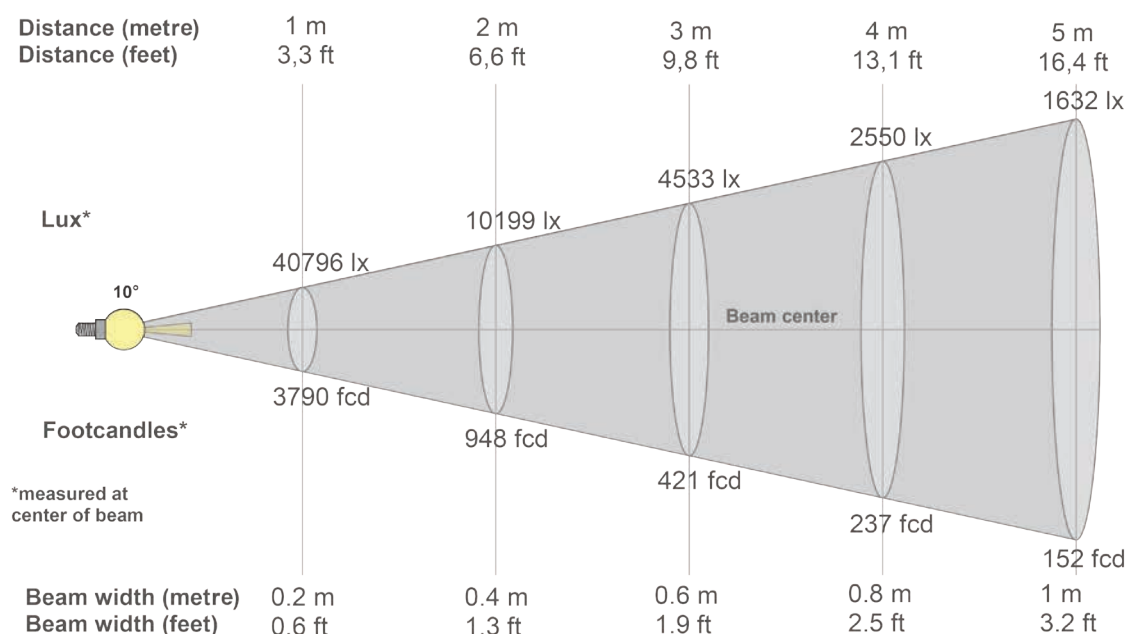

Beam intensities from 1-20m

1m	2m	3m	4m	5m	6m	7m	8m	9m	10m	11m	12m	13m	14m	15m	16m	17m	18m	19m	20m
3.3ft	6.6ft	9.8ft	13.1ft	16.4ft	19.7ft	23ft	26.2ft	29.5ft	32.8ft	36.1ft	39.4ft	42.7ft	45.9ft	49.2ft	52.5ft	55.8ft	59.1ft	62.3ft	65.6ft
40796lx	10199lx	4533lx	2550lx	1632lx	1133lx	833lx	637lx	504lx	408lx	337lx	283lx	241lx	208lx	181lx	159lx	141lx	126lx	113lx	102lx
3790.1fc	947.5fc	421.1fc	236.9fc	151.6fc	105.3fc	77.3fc	59.2fc	46.8fc	37.9fc	31.3fc	26.3fc	22.4fc	19.3fc	16.8fc	14.8fc	13.1fc	11.7fc	10.5fc	9.5fc

Intensities in 0° c-plane

0°	1°	2°	3°	4°	5°	6°	7°	8°	9°	10°	11°	12°	13°	14°	15°	16°	17°	18°	19°
40.8K	40.2K	38.4K	35.1K	30.1K	23.8K	17.4K	11.8K	7.5K	4.6K	2.9K	2.0K	1.5K	1.3K	1.1K	1.0K	0.8K	0.7K	0.5K	0.4K
100%	99%	94%	86%	74%	58%	43%	29%	18%	11%	7%	5%	4%	3%	3%	2%	2%	2%	1%	1%

Intensities in 90° c-plane

0°	1°	2°	3°	4°	5°	6°	7°	8°	9°	10°	11°	12°	13°	14°	15°	16°	17°	18°	19°
40.8K	40.2K	38.4K	35.1K	30.1K	23.8K	17.4K	11.8K	7.5K	4.6K	2.9K	2.0K	1.5K	1.3K	1.1K	1.0K	0.8K	0.7K	0.5K	0.4K
100%	99%	94%	86%	74%	58%	43%	29%	18%	11%	7%	5%	4%	3%	3%	2%	2%	2%	1%	1%

Intensities in 180° c-plane

0°	1°	2°	3°	4°	5°	6°	7°	8°	9°	10°	11°	12°	13°	14°	15°	16°	17°	18°	19°
40.8K	40.2K	38.4K	35.1K	30.1K	23.8K	17.4K	11.8K	7.5K	4.6K	2.9K	2.0K	1.5K	1.3K	1.1K	1.0K	0.8K	0.7K	0.5K	0.4K
100%	99%	94%	86%	74%	58%	43%	29%	18%	11%	7%	5%	4%	3%	3%	2%	2%	2%	1%	1%

Intensities in 270° c-plane

0°	1°	2°	3°	4°	5°	6°	7°	8°	9°	10°	11°	12°	13°	14°	15°	16°	17°	18°	19°
40.8K	40.2K	38.4K	35.1K	30.1K	23.8K	17.4K	11.8K	7.5K	4.6K	2.9K	2.0K	1.5K	1.3K	1.1K	1.0K	0.8K	0.7K	0.5K	0.4K
100%	99%	94%	86%	74%	58%	43%	29%	18%	11%	7%	5%	4%	3%	3%	2%	2%	2%	1%	1%

Beam angle 50%	Field angle 10%	Cutoff angle 2,5%	Intensity ratio in 120° cone	Intensity ratio in 90° cone
11°	18.5°	29.3°	97.3%	95.9%

DW Windsor

Pindar Road, Hoddesdon, EN11 0DX
www.dwwindsor.com | info@dwwindsor.com | +44 (0) 1992 474 600

LuxEOS Flood 9 - RGBA (1700K)

Intensities at Distance with 20° Optics

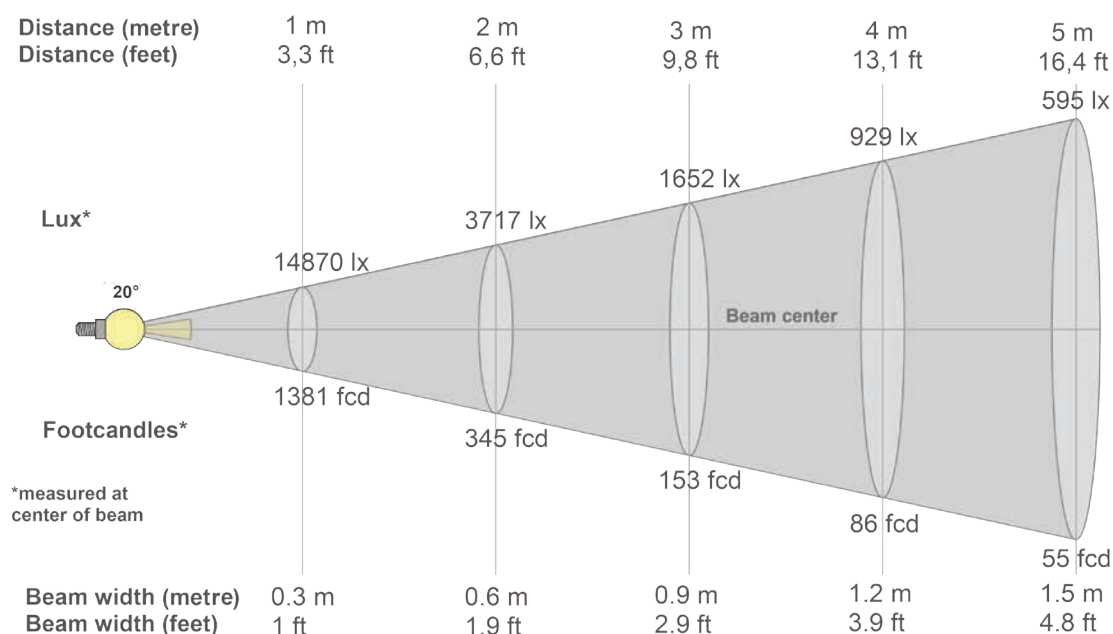

Beam intensities from 1-20m

1m	2m	3m	4m	5m	6m	7m	8m	9m	10m	11m	12m	13m	14m	15m	16m	17m	18m	19m	20m
3.3ft	6.6ft	9.8ft	13.1ft	16.4ft	19.7ft	23ft	26.2ft	29.5ft	32.8ft	36.1ft	39.4ft	42.7ft	45.9ft	49.2ft	52.5ft	55.8ft	59.1ft	62.3ft	65.6ft
14870lx	3717lx	1652lx	929lx	595lx	413lx	303lx	232lx	184lx	149lx	123lx	103lx	88lx	76lx	66lx	58lx	51lx	46lx	41lx	37lx
1381.4fc	345.4fc	153.5fc	86.3fc	55.3fc	38.4fc	28.2fc	21.6fc	17.1fc	13.8fc	11.4fc	9.6fc	8.2fc	7fc	6.1fc	5.4fc	4.8fc	4.3fc	3.8fc	3.5fc

Intensities in 0° c-plane

0°	1°	2°	3°	4°	5°	6°	7°	8°	9°	10°	11°	12°	13°	14°	15°	16°	17°	18°	19°
14.9K	14.7K	14.3K	13.6K	12.6K	11.5K	10.3K	9.1K	7.9K	6.7K	5.6K	4.7K	3.9K	3.1K	2.5K	2.1K	1.7K	1.3K	1.1K	0.9K
100%	99%	96%	91%	85%	78%	70%	61%	53%	45%	38%	32%	26%	21%	17%	14%	11%	9%	7%	6%

Intensities in 90° c-plane

0°	1°	2°	3°	4°	5°	6°	7°	8°	9°	10°	11°	12°	13°	14°	15°	16°	17°	18°	19°
14.9K	14.7K	14.3K	13.6K	12.6K	11.5K	10.3K	9.1K	7.9K	6.7K	5.6K	4.7K	3.9K	3.1K	2.5K	2.1K	1.7K	1.3K	1.1K	0.9K
100%	99%	96%	91%	85%	78%	70%	61%	53%	45%	38%	32%	26%	21%	17%	14%	11%	9%	7%	6%

Intensities in 180° c-plane

0°	1°	2°	3°	4°	5°	6°	7°	8°	9°	10°	11°	12°	13°	14°	15°	16°	17°	18°	19°
14.9K	14.7K	14.3K	13.6K	12.6K	11.5K	10.3K	9.1K	7.9K	6.7K	5.6K	4.7K	3.9K	3.1K	2.5K	2.1K	1.7K	1.3K	1.1K	0.9K
100%	99%	96%	91%	85%	78%	70%	61%	53%	45%	38%	32%	26%	21%	17%	14%	11%	9%	7%	6%

Intensities in 270° c-plane

0°	1°	2°	3°	4°	5°	6°	7°	8°	9°	10°	11°	12°	13°	14°	15°	16°	17°	18°	19°
14.9K	14.7K	14.3K	13.6K	12.6K	11.5K	10.3K	9.1K	7.9K	6.7K	5.6K	4.7K	3.9K	3.1K	2.5K	2.1K	1.7K	1.3K	1.1K	0.9K
100%	99%	96%	91%	85%	78%	70%	61%	53%	45%	38%	32%	26%	21%	17%	14%	11%	9%	7%	6%

Beam angle 50%	Field angle 10%	Cutoff angle 2,5%	Intensity ratio in 120° cone	Intensity ratio in 90° cone
16.8°	33.1°	47.6°	97.0%	94.9%

DW Windsor

Pindar Road, Hoddesdon, EN11 0DX
www.dwwindsor.com | info@dwwindsor.com | +44 (0) 1992 474 600

LuxEOS Flood 9 - RGBA (1700K)

Intensities at Distance with 40° Optics

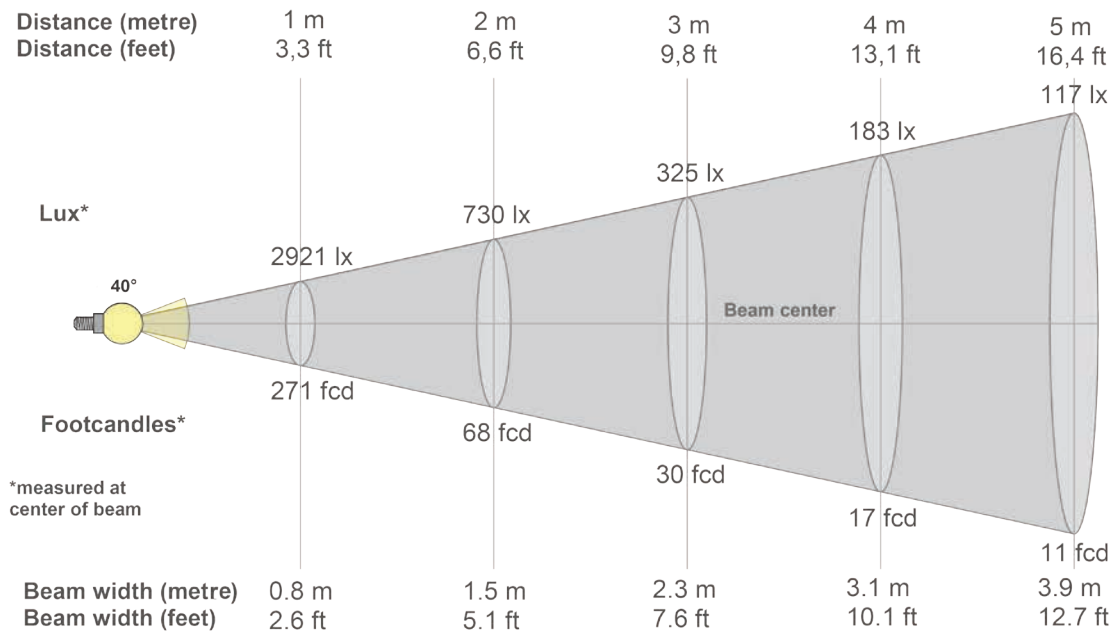

Beam intensities from 1-20m

1m	2m	3m	4m	5m	6m	7m	8m	9m	10m	11m	12m	13m	14m	15m	16m	17m	18m	19m	20m
3.3ft	6.6ft	9.8ft	13.1ft	16.4ft	19.7ft	23ft	26.2ft	29.5ft	32.8ft	36.1ft	39.4ft	42.7ft	45.9ft	49.2ft	52.5ft	55.8ft	59.1ft	62.3ft	65.6ft
2921lx	730lx	325lx	183lx	117lx	81lx	60lx	46lx	36lx	29lx	24lx	20lx	17lx	15lx	13lx	11lx	10lx	9lx	8lx	7lx
271.4fc	67.8fc	30.2fc	17fc	10.9fc	7.5fc	5.5fc	4.2fc	3.4fc	2.7fc	2.2fc	1.9fc	1.6fc	1.4fc	1.2fc	1.1fc	0.9fc	0.8fc	0.8fc	0.7fc

Intensities in 0° c-plane

0°	2°	4°	6°	8°	10°	12°	14°	16°	18°	20°	22°	24°	26°	28°	30°	32°	34°	36°	38°
2921	2909	2869	2803	2708	2584	2431	2250	2046	1824	1593	1364	1148	953	786	647	533	440	364	301
100%	100%	98%	96%	93%	88%	83%	77%	70%	62%	55%	47%	39%	33%	27%	22%	18%	15%	12%	10%

Intensities in 90° c-plane

0°	2°	4°	6°	8°	10°	12°	14°	16°	18°	20°	22°	24°	26°	28°	30°	32°	34°	36°	38°
2921	2909	2869	2803	2708	2584	2431	2250	2046	1824	1593	1364	1148	953	786	647	533	440	364	301
100%	100%	98%	96%	93%	88%	83%	77%	70%	62%	55%	47%	39%	33%	27%	22%	18%	15%	12%	10%

Intensities in 180° c-plane

0°	2°	4°	6°	8°	10°	12°	14°	16°	18°	20°	22°	24°	26°	28°	30°	32°	34°	36°	38°
2921	2909	2869	2803	2708	2584	2431	2250	2046	1824	1593	1364	1148	953	786	647	533	440	364	301
100%	100%	98%	96%	93%	88%	83%	77%	70%	62%	55%	47%	39%	33%	27%	22%	18%	15%	12%	10%

Intensities in 270° c-plane

0°	2°	4°	6°	8°	10°	12°	14°	16°	18°	20°	22°	24°	26°	28°	30°	32°	34°	36°	38°
2921	2909	2869	2803	2708	2584	2431	2250	2046	1824	1593	1364	1148	953	786	647	533	440	364	301
100%	100%	98%	96%	93%	88%	83%	77%	70%	62%	55%	47%	39%	33%	27%	22%	18%	15%	12%	10%

Beam angle 50%	Field angle 10%	Cutoff angle 2,5%	Intensity ratio in 120° cone	Intensity ratio in 90° cone
42.3°	76.6°	105.5°	96.7%	90.9%

DW Windsor

Pindar Road, Hoddesdon, EN11 0DX
www.dwwindsor.com | info@dwwindsor.com | +44 (0) 1992 474 600

LuxEOS Flood 9 - RGBA (1700K)

Intensities at Distance with 80° Optics

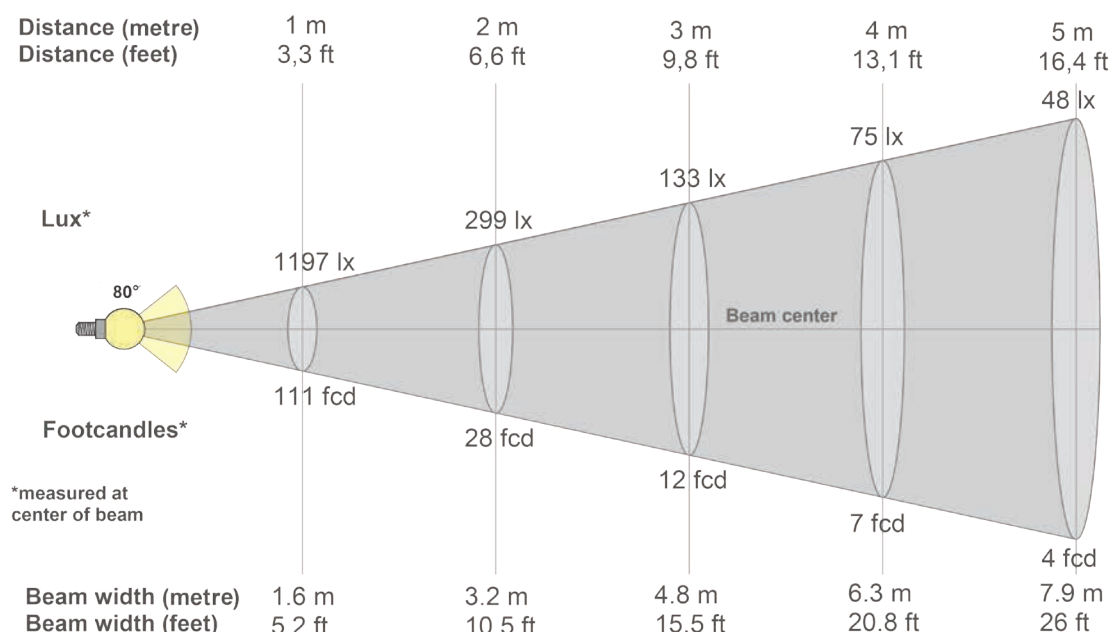

Beam intensities from 1-20m

1m	2m	3m	4m	5m	6m	7m	8m	9m	10m	11m	12m	13m	14m	15m	16m	17m	18m	19m	20m
3.3ft	6.6ft	9.8ft	13.1ft	16.4ft	19.7ft	23ft	26.2ft	29.5ft	32.8ft	36.1ft	39.4ft	42.7ft	45.9ft	49.2ft	52.5ft	55.8ft	59.1ft	62.3ft	65.6ft
1197lx	299lx	133lx	75lx	48lx	33lx	24lx	19lx	15lx	12lx	10lx	8lx	7lx	6lx	5lx	5lx	4lx	4lx	3lx	3lx
111.2fcd	27.8fcd	12.4fcd	7fcd	4.4fcd	3.1fcd	2.3fcd	1.7fcd	1.4fcd	1.1fcd	0.9fcd	0.8fcd	0.7fcd	0.6fcd	0.5fcd	0.4fcd	0.4fcd	0.3fcd	0.3fcd	0.3fcd

Intensities in 0° c-plane

0°	5°	10°	15°	20°	25°	30°	35°	40°	45°	50°	55°	60°	65°	70°	75°	80°	85°	90°	95°
1197	1158	1103	1092	1080	1029	913	733	537	359	216	125	75	47	31	19	9	3	1	0
100%	97%	92%	91%	90%	86%	76%	61%	45%	30%	18%	10%	6%	4%	3%	2%	1%	0%	0%	0%

Intensities in 90° c-plane

0°	5°	10°	15°	20°	25°	30°	35°	40°	45°	50°	55°	60°	65°	70°	75°	80°	85°	90°	95°
1197	1158	1103	1092	1080	1029	913	733	537	359	216	125	75	47	31	19	9	3	1	0
100%	97%	92%	91%	90%	86%	76%	61%	45%	30%	18%	10%	6%	4%	3%	2%	1%	0%	0%	0%

Intensities in 180° c-plane

0°	5°	10°	15°	20°	25°	30°	35°	40°	45°	50°	55°	60°	65°	70°	75°	80°	85°	90°	95°
1197	1158	1103	1092	1080	1029	913	733	537	359	216	125	75	47	31	19	9	3	1	0
100%	97%	92%	91%	90%	86%	76%	61%	45%	30%	18%	10%	6%	4%	3%	2%	1%	0%	0%	0%

Intensities in 270° c-plane

0°	5°	10°	15°	20°	25°	30°	35°	40°	45°	50°	55°	60°	65°	70°	75°	80°	85°	90°	95°
1197	1158	1103	1092	1080	1029	913	733	537	359	216	125	75	47	31	19	9	3	1	0
100%	97%	92%	91%	90%	86%	76%	61%	45%	30%	18%	10%	6%	4%	3%	2%	1%	0%	0%	0%

Beam angle 50%	Field angle 10%	Cutoff angle 2,5%	Intensity ratio in 120° cone	Intensity ratio in 90° cone
76.8°	110.8°	140.5°	95.0%	82.4%

DW Windsor

Pindar Road, Hoddesdon, EN11 0DX
www.dwwindsor.com | info@dwwindsor.com | +44 (0) 1992 474 600

LuxEOS Flood 9 - RGBA (1700K)

Intensities at Distance with 10x60° & 60x10° Optics

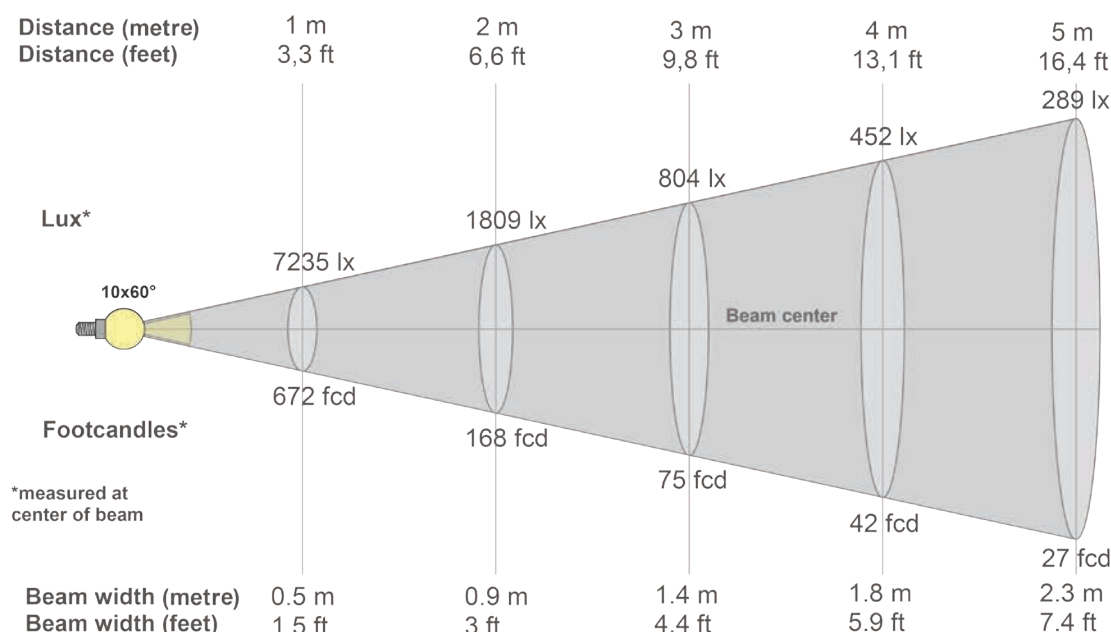

Beam intensities from 1-20m

1m	2m	3m	4m	5m	6m	7m	8m	9m	10m	11m	12m	13m	14m	15m	16m	17m	18m	19m	20m
3.3ft	6.6ft	9.8ft	13.1ft	16.4ft	19.7ft	23ft	26.2ft	29.5ft	32.8ft	36.1ft	39.4ft	42.7ft	45.9ft	49.2ft	52.5ft	55.8ft	59.1ft	62.3ft	65.6ft
7235lx	1809lx	804lx	452lx	289lx	201lx	148lx	113lx	89lx	72lx	60lx	50lx	43lx	37lx	32lx	28lx	25lx	22lx	20lx	18lx
672.1fc	168fc	74.7fc	42fc	26.9fc	18.7fc	13.7fc	10.5fc	8.3fc	6.7fc	5.6fc	4.7fc	4fc	3.4fc	3fc	2.6fc	2.3fc	2.1fc	1.9fc	1.7fc

Intensities in 0° c-plane

0°	2°	4°	6°	8°	10°	12°	14°	16°	18°	20°	22°	24°	26°	28°	30°	32°	34°	36°	38°
7235	6785	6733	6653	6554	6442	6311	6153	5955	5699	5379	4986	4518	3996	3452	2911	2395	1919	1498	1142
100%	94%	93%	92%	91%	89%	87%	85%	82%	79%	74%	69%	62%	55%	48%	40%	33%	27%	21%	16%

Intensities in 90° c-plane

0°	2°	4°	6°	8°	10°	12°	14°	16°	18°	20°	22°	24°	26°	28°	30°	32°	34°	36°	38°
7235	7154	5300	3189	1722	1011	687	488	343	246	183	143	114	92	77	66	56	49	43	38
100%	99%	73%	44%	24%	14%	9%	7%	5%	3%	3%	2%	2%	1%	1%	1%	1%	1%	1%	1%

Intensities in 180° c-plane

0°	2°	4°	6°	8°	10°	12°	14°	16°	18°	20°	22°	24°	26°	28°	30°	32°	34°	36°	38°
7235	6785	6733	6653	6554	6442	6311	6153	5955	5699	5379	4986	4518	3996	3452	2911	2395	1919	1498	1142
100%	94%	93%	92%	91%	89%	87%	85%	82%	79%	74%	69%	62%	55%	48%	40%	33%	27%	21%	16%

Intensities in 270° c-plane

0°	2°	4°	6°	8°	10°	12°	14°	16°	18°	20°	22°	24°	26°	28°	30°	32°	34°	36°	38°
7235	7154	5300	3189	1722	1011	687	488	343	246	183	143	114	92	77	66	56	49	43	38
100%	99%	73%	44%	24%	14%	9%	7%	5%	3%	3%	2%	2%	1%	1%	1%	1%	1%	1%	1%

Beam angle 50%	Field angle 10%	Cutoff angle 2,5%	Intensity ratio in 120° cone	Intensity ratio in 90° cone
25.5°	45.7°	66.1°	97.5%	94.0%

DW Windsor

Pindar Road, Hoddesdon, EN11 0DX
www.dwwindsor.com | info@dwwindsor.com | +44 (0) 1992 474 600



ISO candela diagram

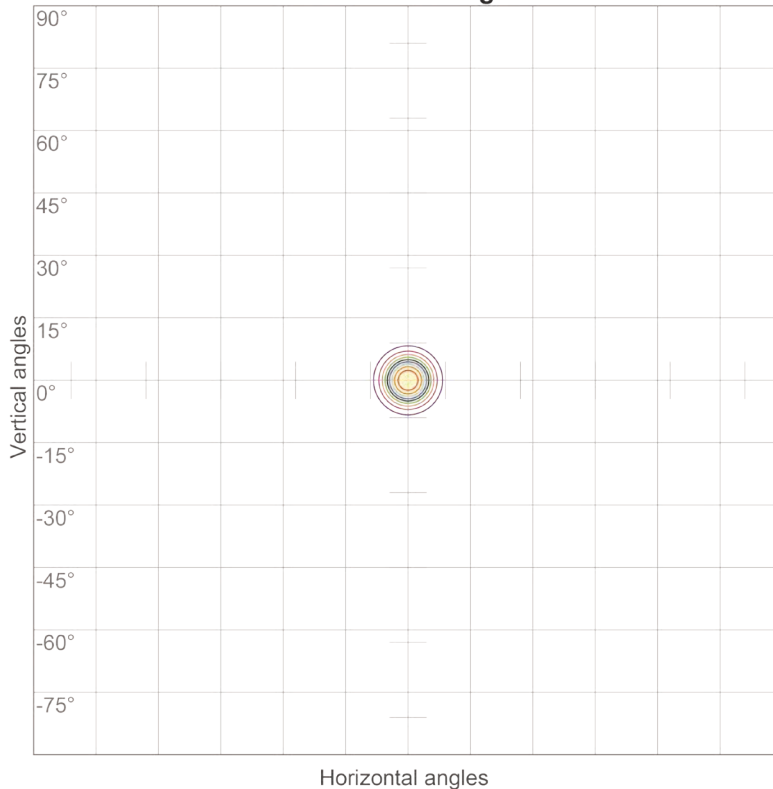

10%	4080 cd
20%	8159 cd
30%	12239 cd
40%	16319 cd
50%	20398 cd
60%	24478 cd
70%	28557 cd
80%	32637 cd
90%	36717 cd

Conditions:

Number of c-planes: 72

Candela at center: 40796 cd

ISO lux diagram

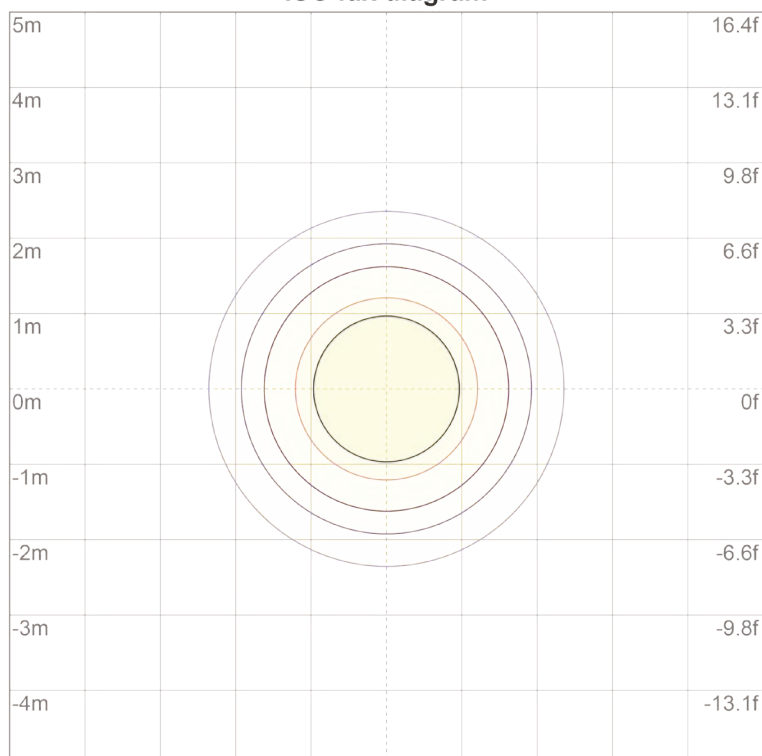

3%	12.2 lx
5%	20.4 lx
10%	40.8 lx
30%	122 lx
50%	204 lx

Conditions:

Number of c-planes: 72

Lux at center: 408 lx

*Lux distribution on a surface
when lamp is mounted at 10
meters from the surface.*



ISO candela diagram

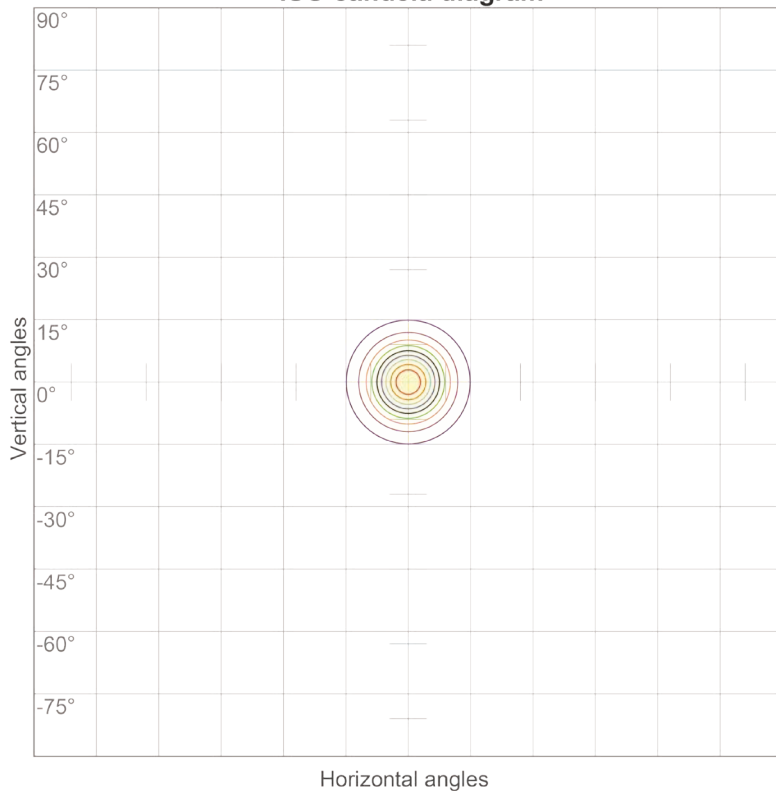

10%	1487 cd
20%	2974 cd
30%	4461 cd
40%	5948 cd
50%	7435 cd
60%	8922 cd
70%	10409 cd
80%	11896 cd
90%	13383 cd

Conditions:

Number of c-planes: 72

Candela at center: 14870 cd

ISO lux diagram

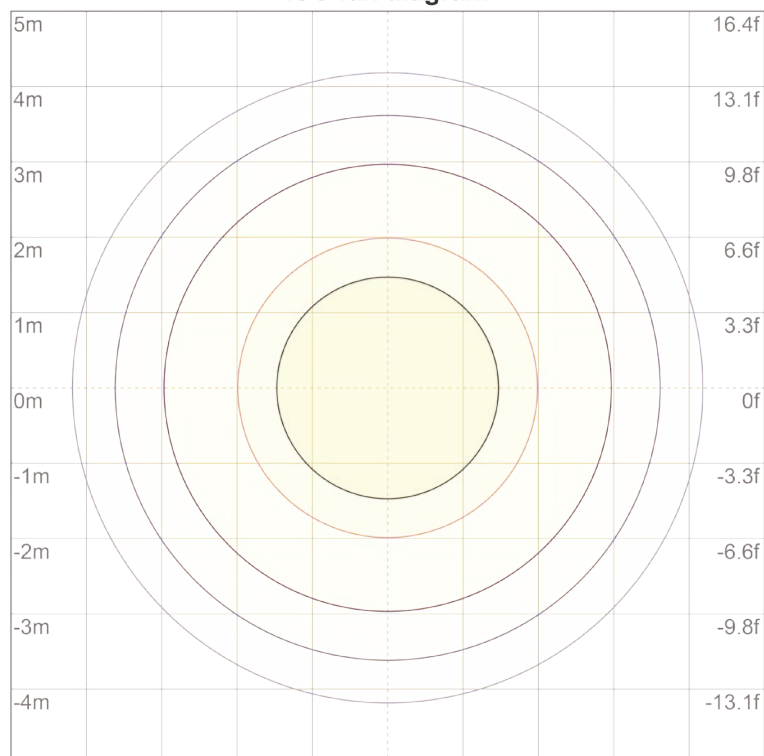

3%	4.46 lx
5%	7.43 lx
10%	14.9 lx
30%	44.6 lx
50%	74.3 lx

Conditions:

Number of c-planes: 72

Lux at center: 149 lx

*Lux distribution on a surface
when lamp is mounted at 10
meters from the surface.*



ISO candela diagram

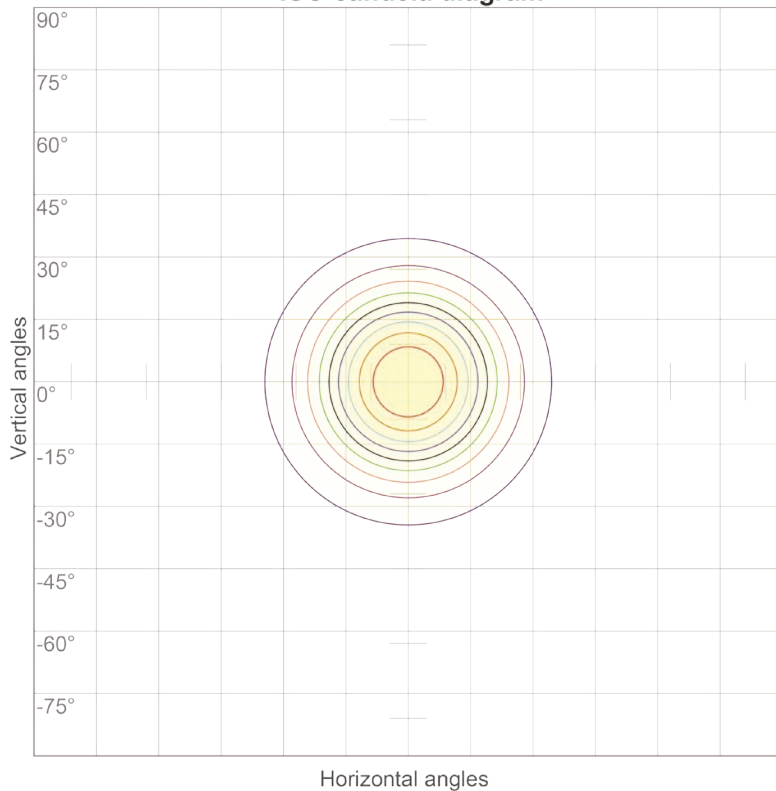

10%	292 cd
20%	584 cd
30%	876 cd
40%	1168 cd
50%	1461 cd
60%	1753 cd
70%	2045 cd
80%	2337 cd
90%	2629 cd

Conditions:

Number of c-planes: 72

Candela at center: 2921 cd

ISO lux diagram

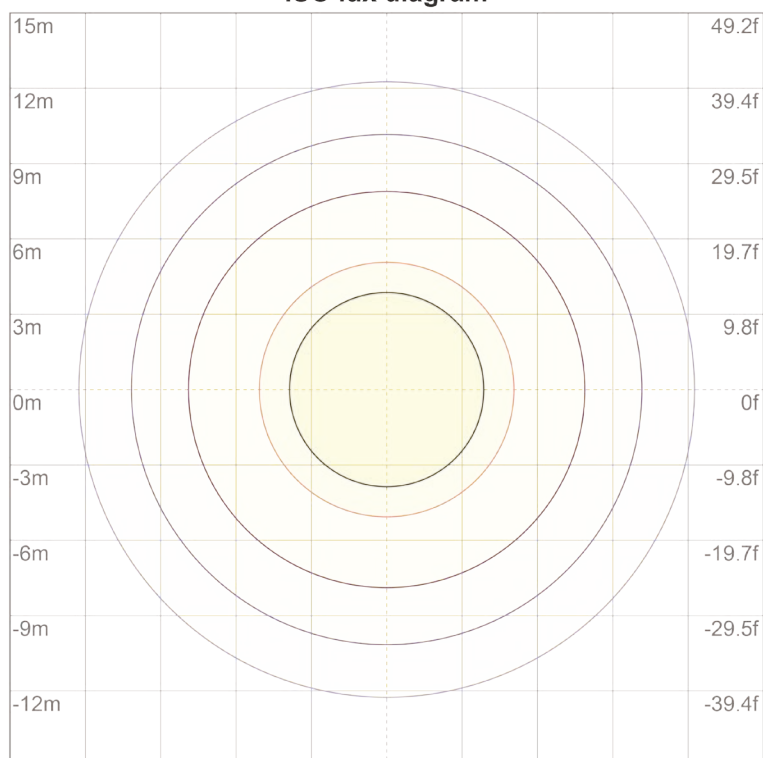

3%	0.876 lx
5%	1.46 lx
10%	2.92 lx
30%	8.76 lx
50%	14.6 lx

Conditions:

Number of c-planes: 72

Lux at center: 29.2 lx

*Lux distribution on a surface
when lamp is mounted at 10
meters from the surface.*



ISO candela diagram

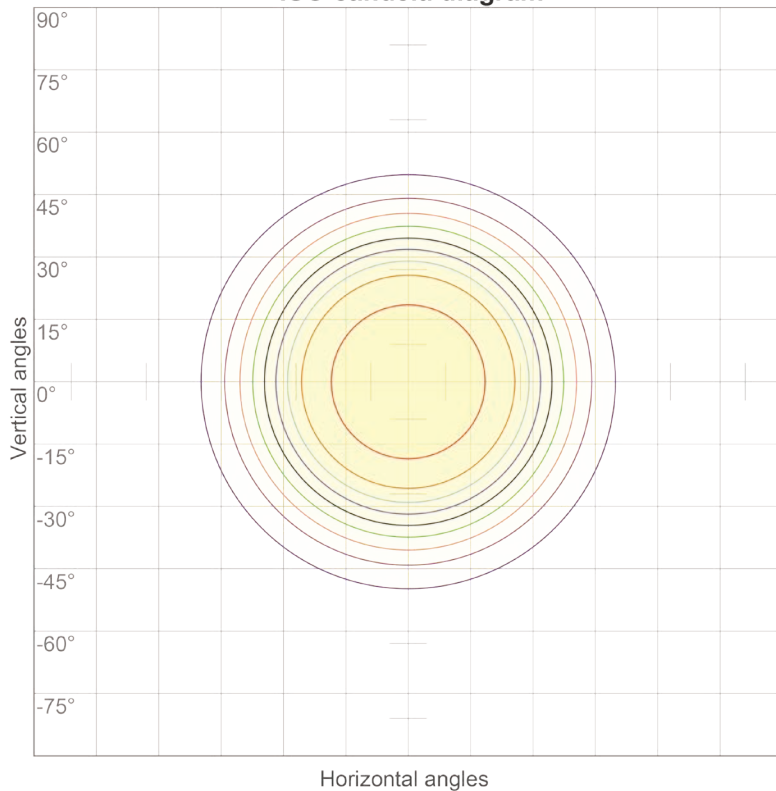

10%	120 cd
20%	239 cd
30%	359 cd
40%	479 cd
50%	599 cd
60%	718 cd
70%	838 cd
80%	958 cd
90%	1078 cd

Conditions:

Number of c-planes: 72

Candela at center: 1197 cd

ISO lux diagram

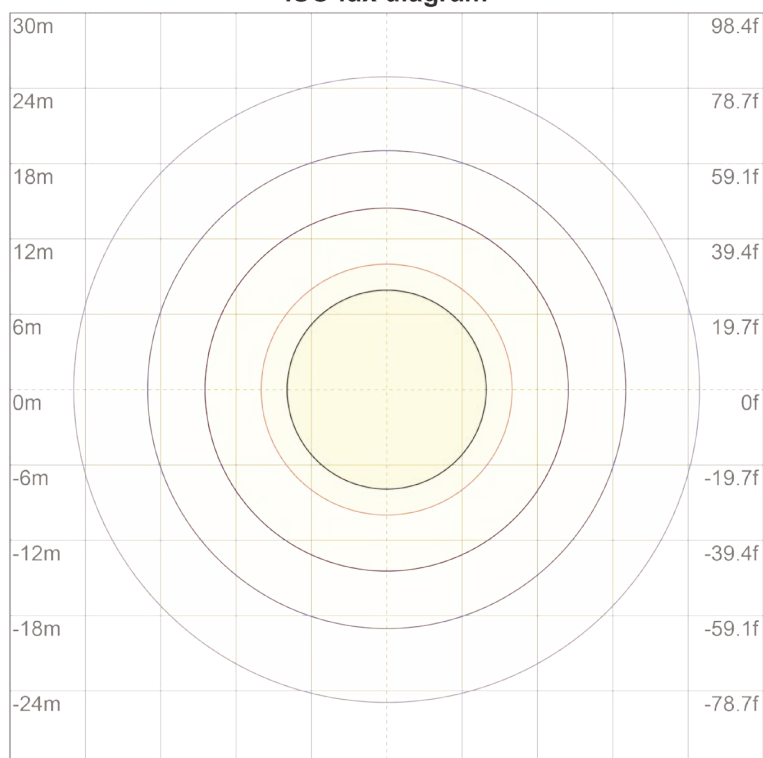

3%	0.359 lx
5%	0.599 lx
10%	1.20 lx
30%	3.59 lx
50%	5.99 lx

Conditions:

Number of c-planes: 72

Lux at center: 12.0 lx

*Lux distribution on a surface
when lamp is mounted at 10
meters from the surface.*



ISO candela diagram

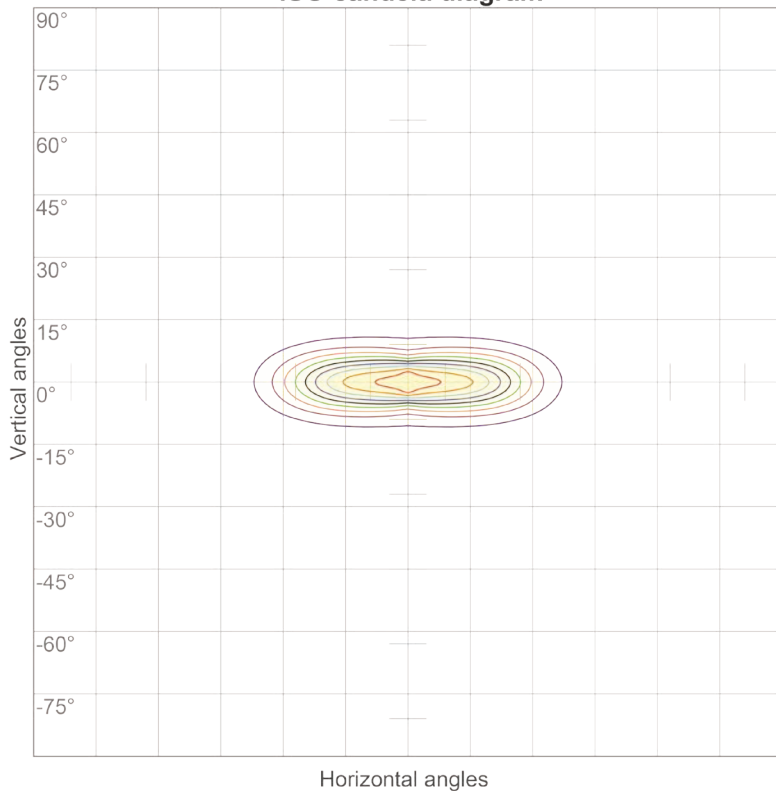

10%	723 cd
20%	1447 cd
30%	2170 cd
40%	2894 cd
50%	3617 cd
60%	4341 cd
70%	5064 cd
80%	5788 cd
90%	6511 cd

Conditions:

Number of c-planes: 72

Candela at center: 7235 cd

ISO lux diagram

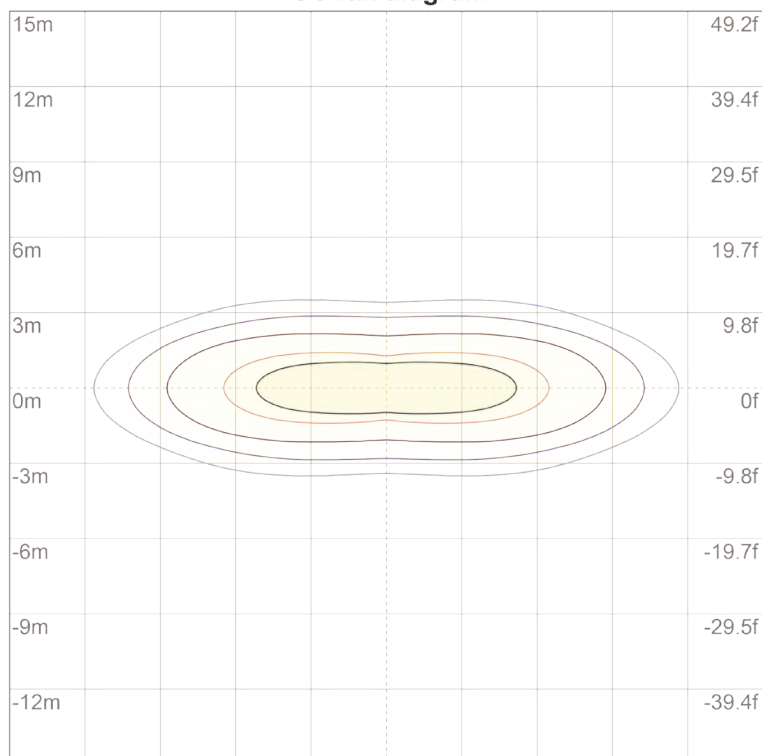

3%	2.17 lx
5%	3.62 lx
10%	7.23 lx
30%	21.7 lx
50%	36.2 lx

Conditions:

Number of c-planes: 72

Lux at center: 72.3 lx

*Lux distribution on a surface
when lamp is mounted at 10
meters from the surface.*

PULSAR

LuxEOS Flood 9 - RGBA (1700K)

Colormetrics **RGBA**



PHOTOMETRIC DATA

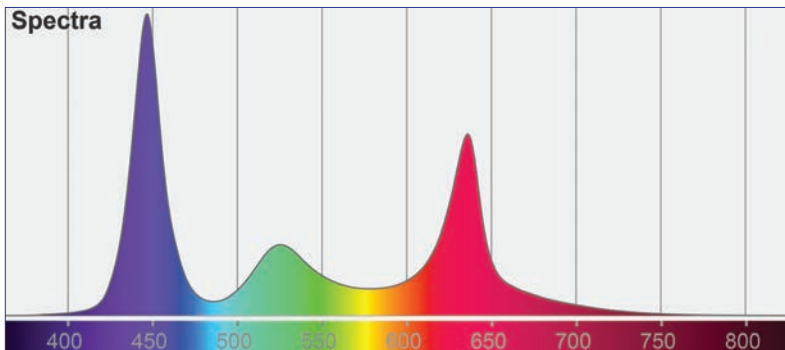

Total Lumen Output (Native) : 1937 lm

Efficacy : 32.3 lm/W

Voltage : 240V

Supply Power : 60W

Supply Power Factor : 0.96

CIE 1931

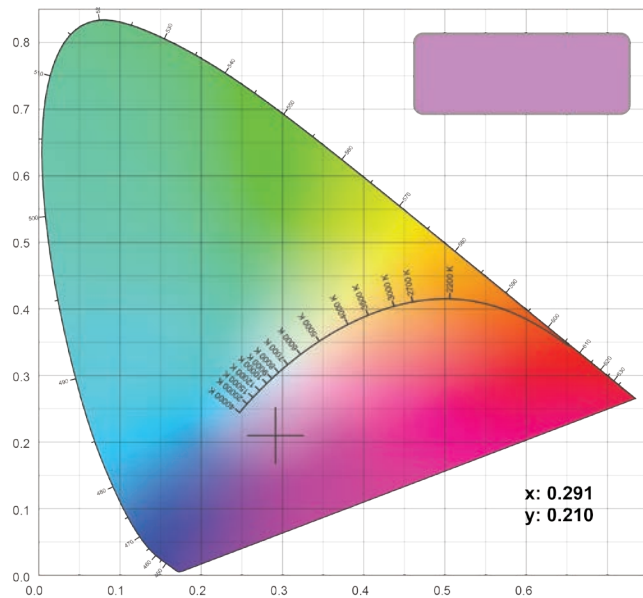

CIE 1931 Zoom

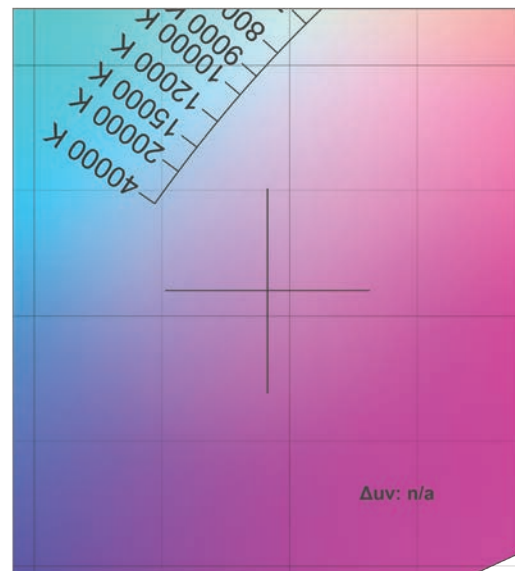

PULSAR

LuxEOS Flood 9 - RGBA (1700K)

Colormetrics **RED**



PHOTOMETRIC DATA

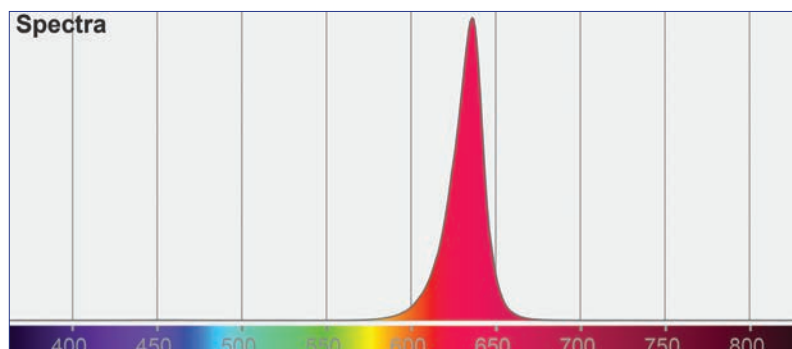

Red Lumen Output : 527 lm

CIE 1931

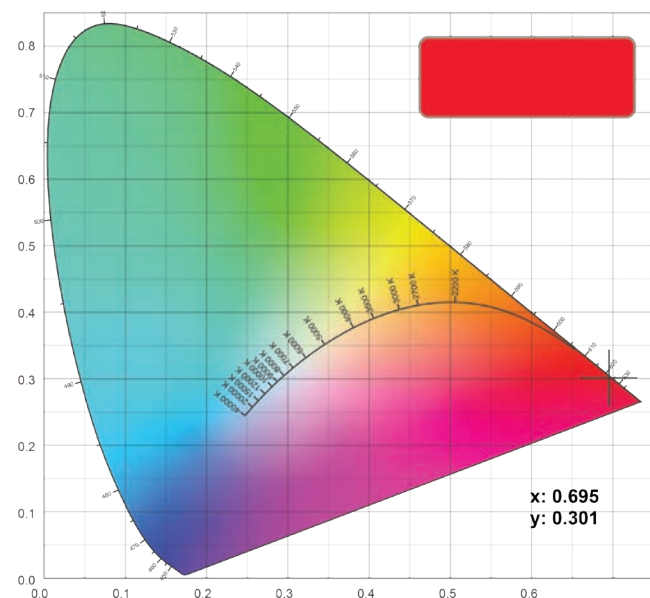

CIE 1931 Zoom

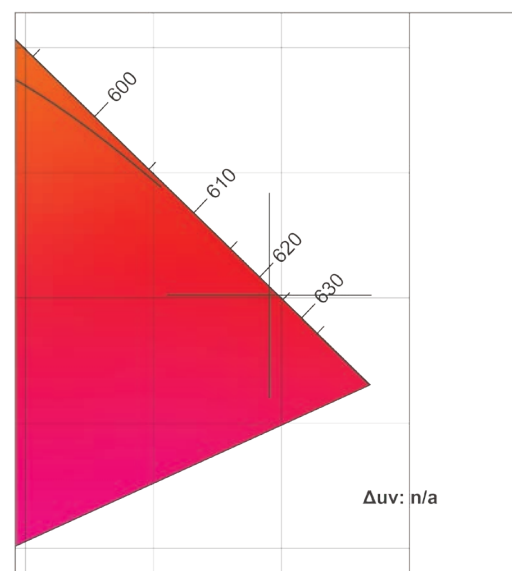

LuxEOS Flood 9 - RGBA (1700K)

Colormetrics **GREEN**

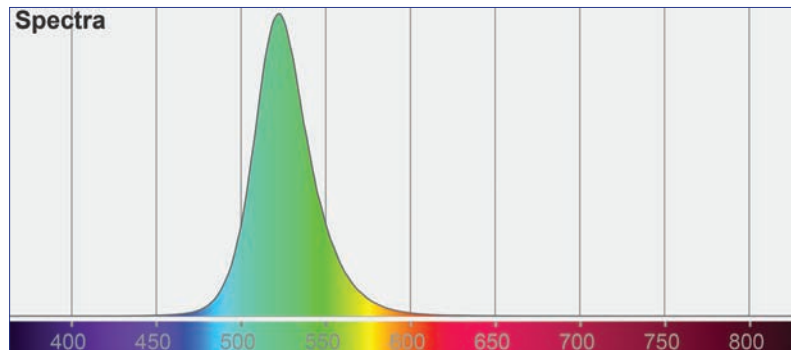

Green Lumen Output : 809 lm

CIE 1931

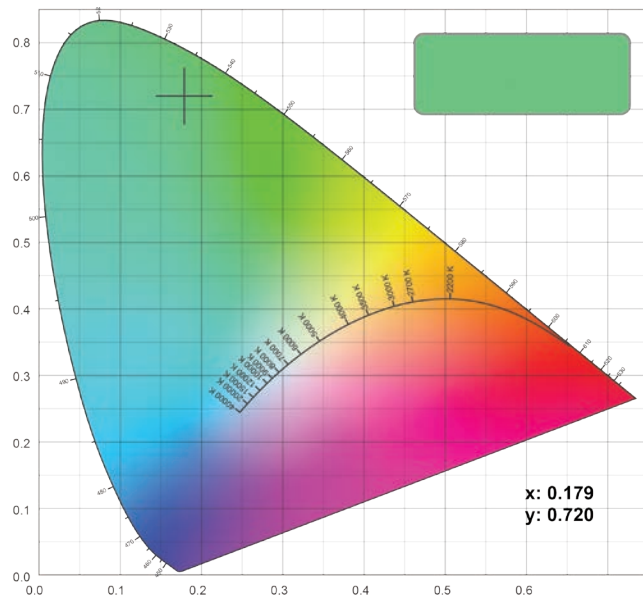

CIE 1931 Zoom

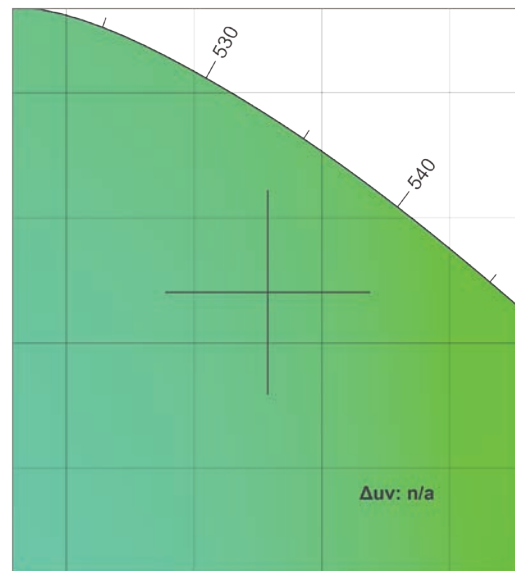

LuxEOS Flood 9 - RGBA (1700K) Colormetrics **BLUE**

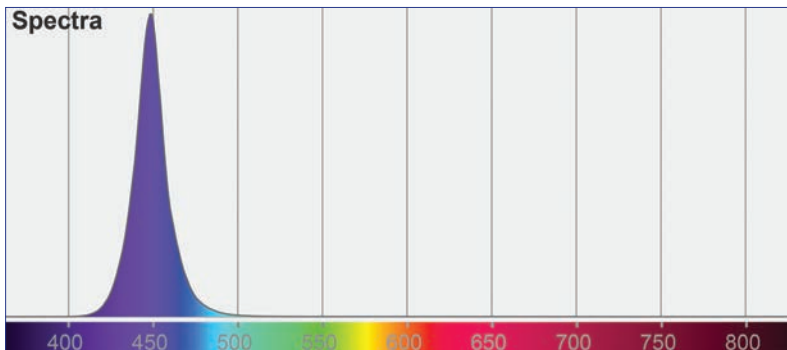

Blue Lumen Output : 178 lm

CIE 1931

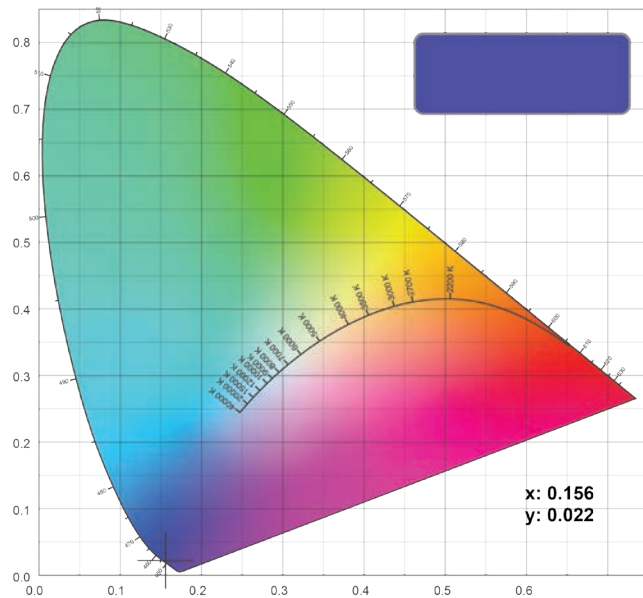

CIE 1931 Zoom

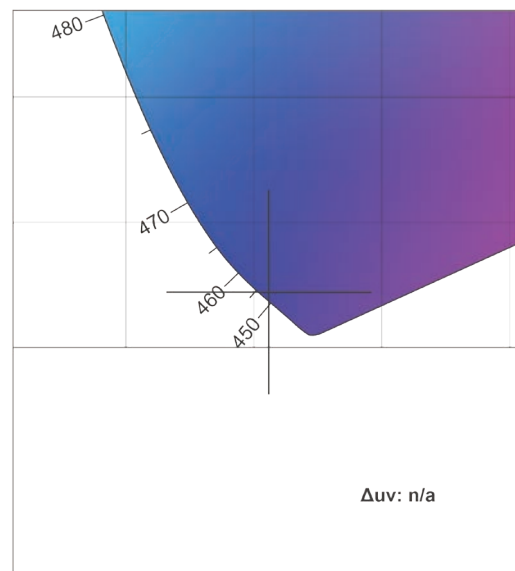

PULSAR

LuxEOS Flood 9 - RGBA (1700K)

Colormetrics **AMBER 1700K**



PHOTOMETRIC DATA

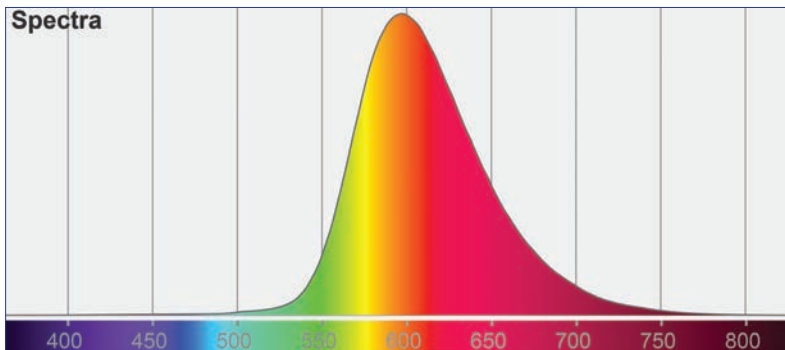

Amber 1700K Lumen Output : 984 lm

CIE 1931

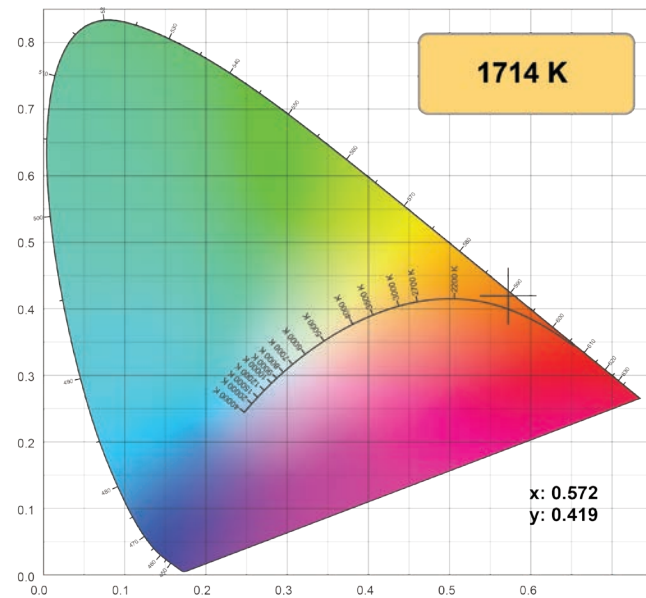

CIE 1931 Zoom

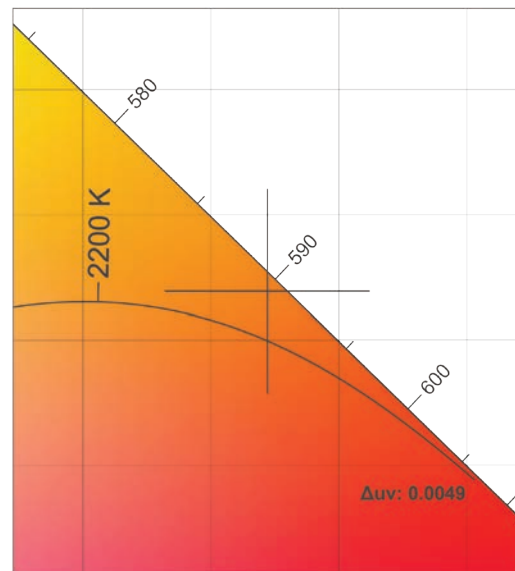

Should further photometric variations be required, please contact our Head Office.

As part of our commitment to continuous improvement PULSAR may change the specifications of its products without prior notification or public announcement. All descriptions, illustrations, drawings and specifications in this publication present only general particulars and shall not form part of any contract.

DW Windsor

Pindar Road, Hoddesdon, EN11 0DX

www.dwwindsor.com | info@dwwindsor.com | +44 (0) 1992 474 600